

Welcome to the East Area Planning Committee

- This planning committee meeting is held in public but it is not a public meeting.
- There will be an opportunity for the public to address the committee on each application.
- If you wish to speak for or against a planning application, you need to have either requested it in advance, or hand in one of the available speaker forms, or speak to the clerk.
- Information on meeting protocol and conduct at the committee is set out in the Code of Practice.
- This is in the committee agenda just before the first planning application report.

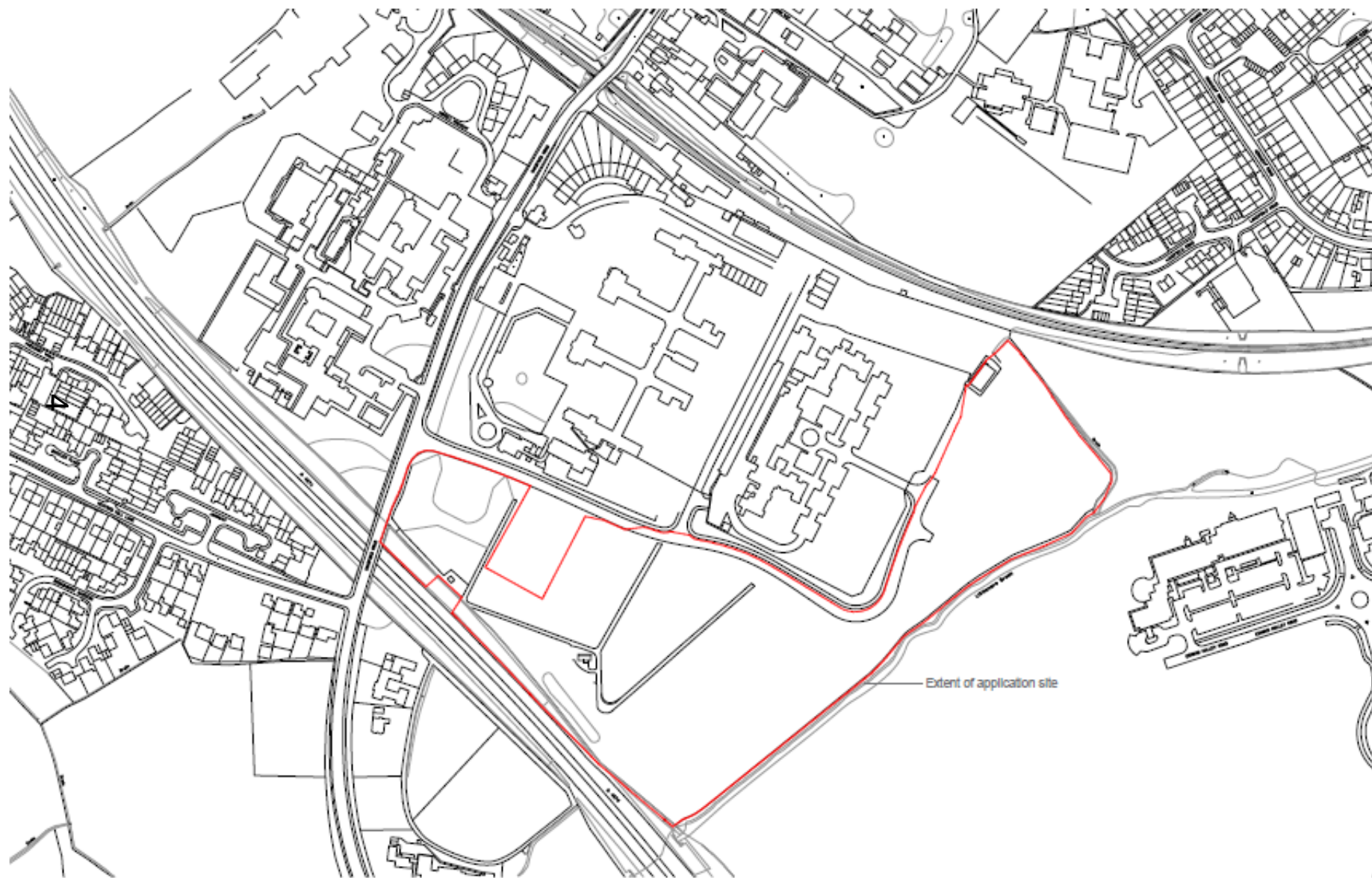

Site Location Plan





Armstrong Road / Sandford Road Junction



The Copse at north-western end of site



View of north-western section of site alongside nursery



View of north-western section of site alongside nursery



6

View of middle section of site looking towards Armstrong Road



View of middle section of site looking towards Science Park



11

View from middle section looking towards A4074



View of entrance to St Georges Manor from Armstrong Road



13

View of Armstrong Road from middle section of site looking towards Sandford Road



View from Armstrong Road looking towards Sandford Road



View of bottom end of Armstrong Road



View of entrance to SAE Institute from the end of Armstrong Road

17

View from north-eastern edge of site looking westwards



View from north-eastern edge of site looking towards SAE Institute

A wide-angle photograph of a grassy field with scattered trees and a cloudy sky. The field is covered in green grass with patches of dry, brownish vegetation. Several trees are scattered across the field, including a prominent evergreen on the left and a small tree with reddish leaves in the center. In the background, a line of trees and some buildings are visible under a bright blue sky with large, white, fluffy clouds.

View from north-eastern part of the site looking towards Science Park

A wide-angle photograph of a grassy field with a line of trees and buildings in the background under a blue sky with white clouds. The field is covered in green and brown grass, with some bare trees and shrubs in the mid-ground. In the background, there are several long, low buildings, likely part of Science Park. The sky is bright blue with scattered white clouds.

View from of north-eastern part of the site looking towards Science Park



Illustrative Masterplan Littlemore Park

Based upon Topographical Survey carried out for CAPITA by D & H Surveys, November 2013.

Littlemore Park Outline Planning Application
CS_089066
September 2014

CAPITA
Capita, St David's House
Pearce Close, St Mellons
Cardiff
CF3 0LG

Parameter Plan 1



Parameter Plan 2



Parameter Plan 3



Parameter Plan 4



Parameter Parking Plan



Illustrative Sections

27



This page is intentionally left blank